

ACKNOWLEDGMENT

COMMONWEALTH OF PENNSYLVANIA)
COUNTY OF CENTRE) SS:

On this, the 31st day of March, 1989, before me, the undersigned officer, personally appeared MARIAN UNGAR COPPERNUTH, who being duly sworn according to law, deposes and says that she is the owner and/or equitable owner of the property shown on this sheet, and that this sheet represents a correction of the same sheet of the original plans filed on January 16, 1989, and is an Exhibit to the Supplemental and Correction to Declaration of the Towers, a Condominium, dated March 29, 1989.

Marian Ungar Coppernuth
Marian Ungar Coppernuth

Neil L. Hirschman (SEAL)
Notary Public
My Commission Expires:

NOTARIAL SEAL
NEIL L. HIRSCHMAN
NOTARY PUBLIC
CENTRE COUNTY, PENNSYLVANIA

See correction on Book 390 P. 2 of

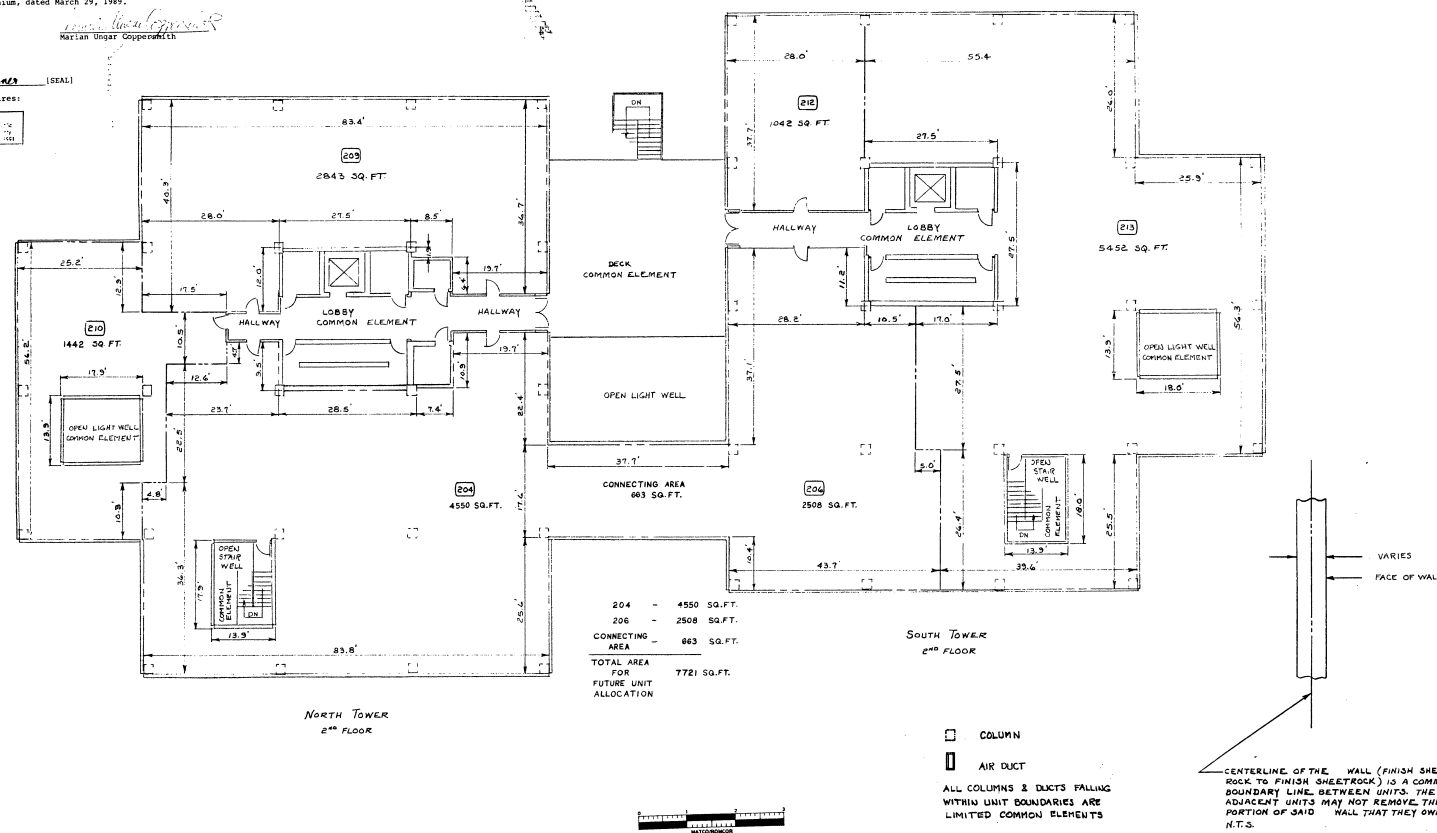

<p>CENTRE COUNTY RECORDER'S CERTIFICATE Recorded on this the <u>31st</u> day of <u>March</u>, 1989, in the Office of the Recorder of Deeds of Centre County in Plat Book <u>390</u>, Page <u>210</u>, given under my hand and seal of the said office on the date above written.</p> <p><u>Robert M. Litten</u> Recorder</p>	<p>GRAPHIC SCALE 0 10 20 30 40 1 inch = 10 feet</p>	<p>THE TOWERS CONDOMINIUM DECLARATION PLAN State College Borough • Centre County • Pennsylvania</p>	<p>REVISIONS V2088 - JUL - CORRECT AREA = 210 V2089 - JUN - AREA = 204.208</p> <p>KERRY A. UHLER & ASSOCIATES Consulting Engineers 1800 HIGH STREET BELLEFONTE, PENNA. 16823</p> <p>SCALE 1" = 10' DR. BY <u>KAU</u> DRAWING NO. DATE 12-15-88 CK'D. BY <u>KAU</u> 4 OF 10</p>
---	---	--	--

BK - 39 PG - 210